

HOLE 801011
 COORDINATES 35°95'N, 00°43'W
 COLLAR ELEVATION 1169 m
 AZIMUTH 063 DIP -75
 DEPTH 82.4 (272')

SECTION FACING NORTH

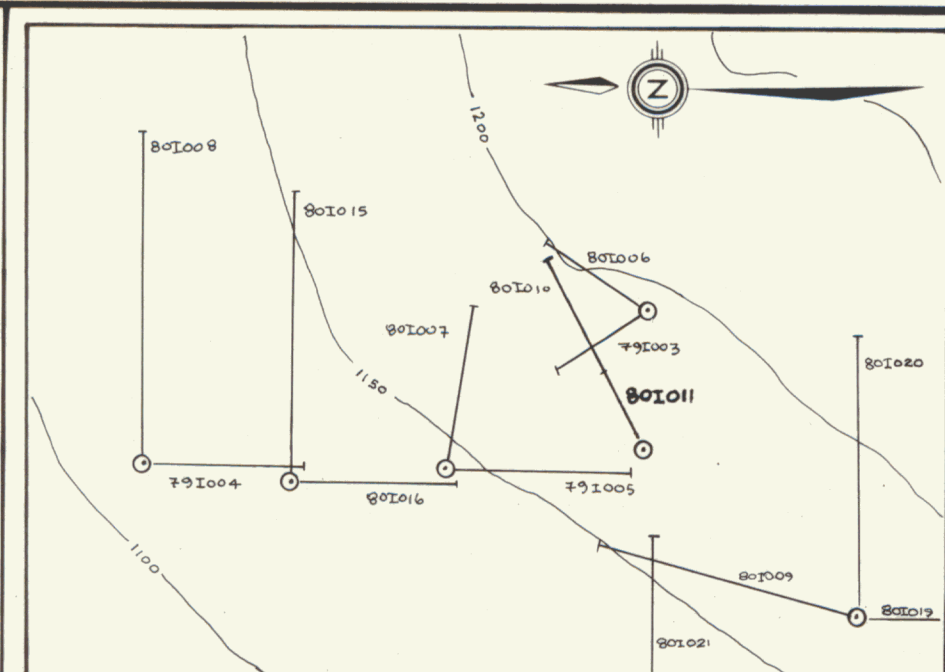

LOCATION MAP SCALE 1:2500



LEGEND

- HELIKIAN**
- ▲ ▲ Iron-Rich Breccia (HB4): high but variable concentrations of euhedral to massive magnetite-hematite with associated barite, pyrite, chalcopyrite & carbonates, both in matrix & replacing breccia fragments
 - ● Chert Breccia (HB5): dark green chert matrix & fragments often hematitic, associated with HB4 & fault zones
 - ▲ ▲ Red-Brown Breccia (HB6): heterolithic breccia with carbonate, chlorite & hematite matrix containing altered, subrounded fragments. Pink to red-brown > grey to light green fragments. Breccia varies from matrix to fragment supported. Rarely foliated
 - ○ Light Green Breccia (HB2): strongly foliated, silvery-grey to red-brown weathering breccia consisting of light green phylite fragments in a pink to red-brown matrix. Breccia is always fragment supported. Weathers recessively compared to HB1
- HELIKIAN, APHEBIAN?**
- ■ Quarrel Group (HS): grey to black shale, silt & phylite interbedded with quartzites & siltstones exhibiting turbidite structures
 - ■ Altered Quarrel Group (HSa): bleached, hematized & carbonatized equivalent of HS, pale green phylites, brown weathering grey siltstones and white-pink quartzites, occasionally limy
- ~ ~ ~ fault
- [] ppm U
- [] ppm Cu
- [] ppm Co

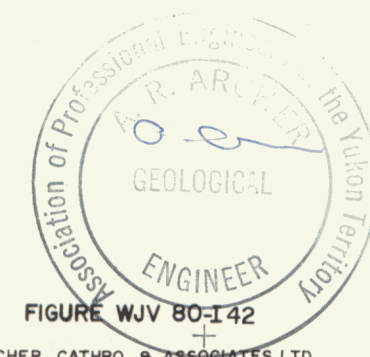

FIGURE WJV 80-142
 ARCHER, CATHRO & ASSOCIATES LTD

SECTION HOLE 801011

090756

IGOR PROPERTY

WERNECKE JOINT VENTURE

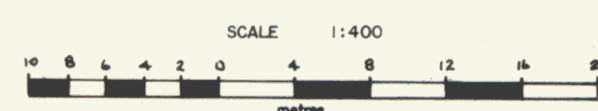

To accompany report dated **JAN 23 1981**